

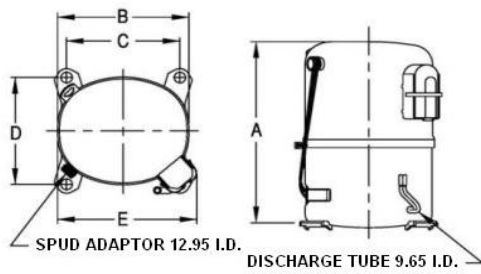

**PRINCIPAL DIMENSIONS - mm**



A: 324	B: 223	C: 191	D: 191	E: 239
--------	--------	--------	--------	--------

**SCHEMATIC WIRING DIAGRAM -**

-

**SCHEMATIC WIRING DIAGRAM 3 PHASE**

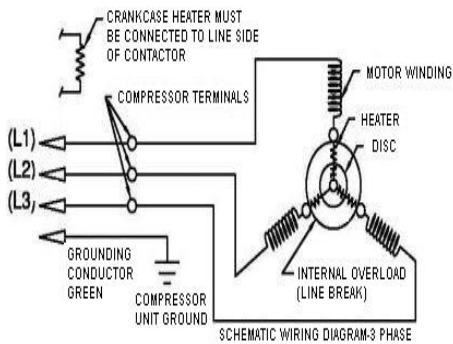

**MOUNTING KIT**

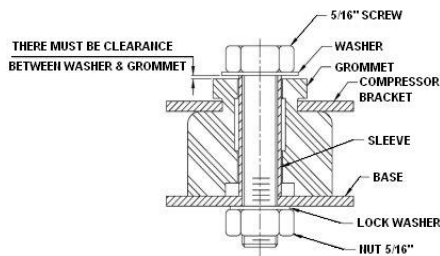

Electrical : 380-420 V/50 Hz., 460 V/60 Hz. 3 Phase

**Nominal Performance**

Capacity	5,143 / 6,213 Watts	
	17,548 / 21,199 BTU/Hr	
	4,422 / 5,342 Kcal/Hr	
Power Input	1,700 / 2,020 Watts	
Locked Rotor Amps	24.00 / 24.00 Amps	
Max Continuous Current	- / - Amps	
Rated Load Amps	2.80 / 2.80 Amps	
COP	3.03 / 3.08 Watts / Watts	
EER	10.32 / 10.49 BTU/W-Hr	

**Testing Conditions**

Condensing Temperature	54.40 °C	129.9 °F
Evaporating Temperature	7.20 / - °C	45.0 / - °F
Liquid Temperature	46.10 °C	115.0 °F
Return Gas Temperature	35.00 °C	95.0 °F
Ambient Temperature	35.00 °C	95.0 °F

**Application**

Evaporating Temp. Range	HBP, A/C	@ 0.00 ° C to 13.00 ° C (32.0° F to 55.4° F)
	Heat Pump	- ° C to - ° C (-° F to -° F)
Refrigerant	R22	
Refrigerant Flow Control	Capillary Tube	
Compressor Cooling	Fan	

**Compressor and Motor data**

Compressor Type	Reciprocating
Displacement	39.60 cc.
Oil Type	Mineral Oil
Oil Charge	964 cc.
Motor Type	3 PHASE ; 2 Pole 2,850 / 3,450 r/m
Voltage Range	342-462/414-506 Volts 50/60 Hz.

**Winding Resistance at 25 ° C**

L1-L2	6.95 Ohms
L1-L3	6.95 Ohms
L2-L3	6.76 Ohms

Weight with Oil	27.67 Kg.
Weight with Oil and Accessories	27.89 Kg.

**Electrical Components**

<b>Motor Protector</b>	
Type	Internal Overload
Model Number	KGE 658-2
Open / Close	105-115 / 52-70 ° C
1st Cycle trip at 25 ° C	- Amps(main) 19.00 Amps(start)
<b>Motor Starter (CSR Only)</b>	
Type	-
Model Number	-
Pick Up (max.)	- Volts
Drop Out (min.)	- Volts
Terminal Cover	KGM 901-2
Start Capacitor (CSR Only)	No µF No VAC.
Disch Resistor for Start Cap	-
Run Capacitor	No µF No VAC.

**Mounting Kit**

Rubber Grommet	KGM 905
Sleeve Grommet	KGM 903-2
Washer	-

Since we are constantly improving our product , the specification are subject to change without notice.

REV. DATE	C / N No.
09-01-14	0486/13

**Certificate Marks**

**COMPRESSOR PERFORMANCE TABLE**